

TM9-2320-211-34P

(1) (2) (3) (4) (5) (6) (7) (8) (9) (10)

SMR Federal DESCRIPION UNIT OF MEASUREMENT UNIT OF MEASUREMENT UNIT OF MEASUREMENT UNIT OF MEASUREMENT UNIT OF MEASUREMENT UNIT OF MEASUREMENT UNIT OF MEASUREMENT UNIT OF MEASUREMENT UNIT OF MEASUREMENT UNIT OF MEASUREMENT

Code Stock Code of inc. allowance allowance alw maint per alw equip100 Figure Item No.

Number meas in Unit 100 per (a) (b)

Reference Number & Mfr. Code Usable On Code 1-20 21-5(51-10(1-20 21-5(51-10(gcy

1601-SPRINGS-CONTINUED

P-O	5310-012-03	NUT, SELF-LOCKING: 120371 (21450)	HA, JA BD	EA	2	*	*	*	*	*	*	*	*	125	12
P-O	5310-957-71	NUT, SELF-LOCKING: MS35691-705 (96906)	A	EA	4	*	*	*	*	*	*	*	*	125	13
P-O	5305-717-39	SCREW, CAP, HEXAGON: MS90725-103 (96906)	A	EA	4	*	*	*	*	*	*	*	*	125	14
P-O	5310-740-96	WASHER, FLAT: 7409615 (19207)	A	EA	2	*	*	*	*	*	*	*	*	126	1
P-O	5330-740-93	WASHER, NONMETALLIC: 7409312 (19207)	A	EA	3	*	*	*	*	*	*	*	*	126	2
P-O	2510-740-96	RETAINER, PACKING: SEAT BEARING FELT 7409606 (19207)	A	EA	2	*	*	*	*	*	*	*	*	126	3
P-O	2530-740-95	RING, WIPER: HUB BEARING OIL SEAA 7979766 (19207)	A	EA	2	*	*	*	*	*	6	10	126	4	
P-O	2520-740-95	SEAL, PLAIN, ENCASED: SEAT BEARING 7409550 (19207)	A	EA	2	*	*	*	*	*	10	200	126	5	
P-O	3110-198-14	CONE AND ROLLERS, TAPERED: 712286 (21450)	A	EA	2	*	*	*	*	*	8	10	126	6	
P-O	5306-740-96	BOLT, MACHINE: SPRING SEAT 7409608 (19207)	A	EA	4	*	*	*	*	*	6	10	126	7	
X2-O		WASHER, LOCK: SPRING SEAT 131050 (21450)	A	EA	4	*	*	*	*	*			126	8	
P-O	2510-741-87	SEAT ASSEMBLY, BEARING CUP: 7418773 (19207)	A	EA	2	*	*	*	*	*	8	10	126	9	
P-O	3110-142-43	CUP, TAPERED ROLLER BEARING: 706691 (12742)	A	EA	2	*	*	*	*	*	6	10	126	10	
P-O	3110-100-06	CONE AND ROLLERS, TAPERED: 705155 (12742)	A	EA	2	*	*	*	*	*	6	10	126	11	
P-O	5310-353-22	NUT, PLAIN, OCTAGON: 7409603 (19207)	A	EA	2	*	*	*	*	*	6	10	126	12	
PO	5310-700-70	WASHER, KEY: SEAT NUT 7007089 (19207)	A	EA	2	*	*	*	*	*	6	10	126	13	
P-O	5310-353-24	NUT, PLAIN, OCTAGON: 7346885 (19207)	A	EA	2	*	*	*	*	*	6	10	126	14	
P-O	2510-740-96	GASKET: SEAT BEARING CAP 7409600 (19207)	A	EA	2	*	*	*	*	*	10	200	126	15	
P-O	2510-740-93	COVER, ACCESS: 7409391 (19207)	A	EA	2	*	*	*	*	*	3	5	126	16	

Current part is item (2) on diagram. Available at www.oshkoshequipment.com

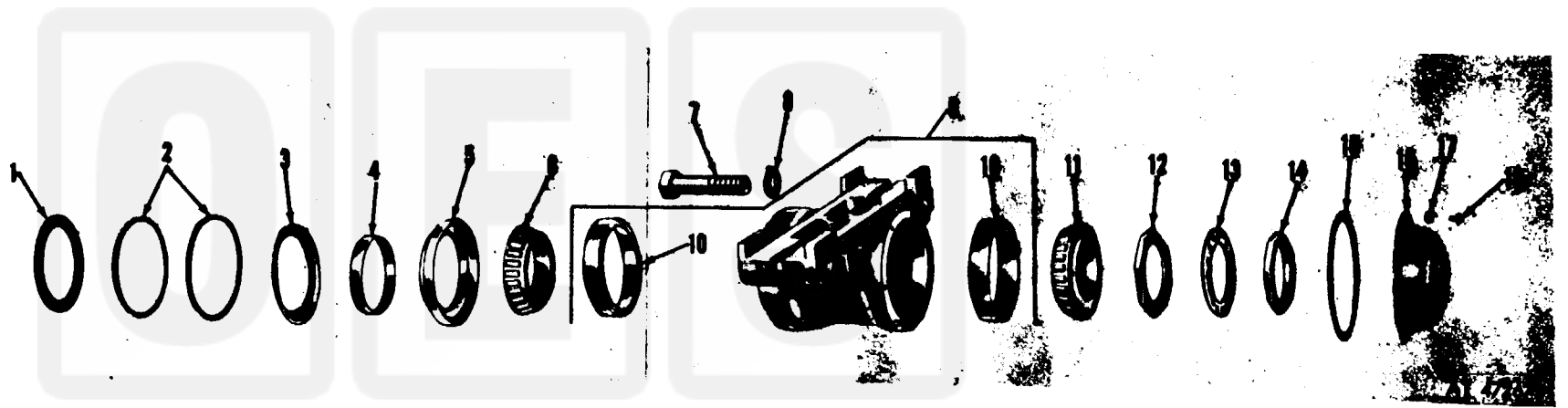

Figure 126. Rear spring seat and bearing.

Oshkosh
Equipment Sales

Current part is item (2) on diagram. Available at www.oshkoshequipment.com